

# MG-30 Firmware Update Guide

## IMPORTANT NOTICE:

1. Please back up all your presets with the existing Quick Tone Editor on your computer before upgrading the firmware, or you'll lose all your(user) presets.
2. After the firwmare is upgraded, please reset your MG-30 to factory default settings.
3. Load your presets to your MG-30 with the new Quick Tone Editor.

- Download the firmware

1. Visit <https://www.nuxefx.com/mg-30.html> using your preferred browser.
2. Scroll the page down a little bit , click the **Support** tag to jump down to the **Support** section of the product page. This is where you can find the documentations, new firmware, editor software and drivers etc.

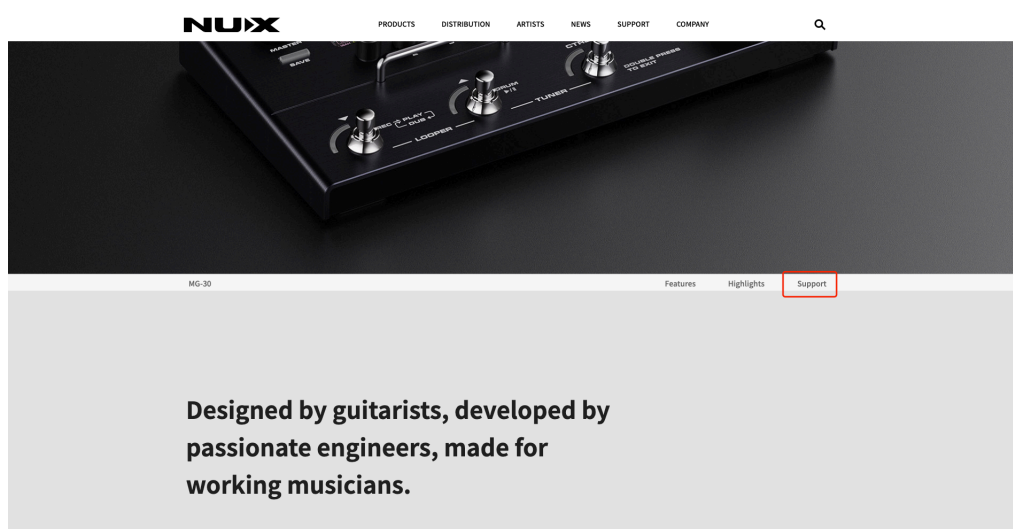

3. Download either the Windows or Mac firmware update kit depending on your operating system.
4. Unzip the downloaded file, you should can see a folder containing one "Nux Device Updater" and a .bin file(firmware itself).

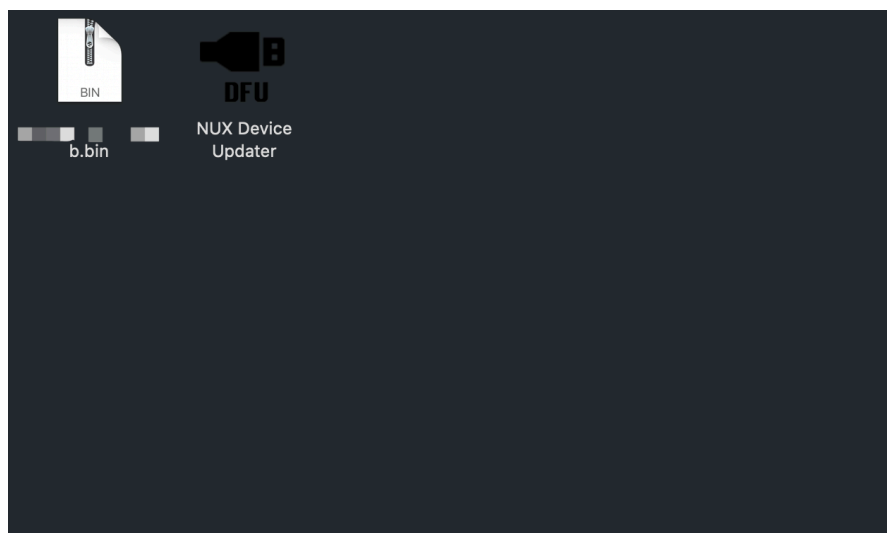

- Connect MG-30 to your computer & Active the update mode.
  1. Connect MG-30 to your computer using the included USB-C cable.

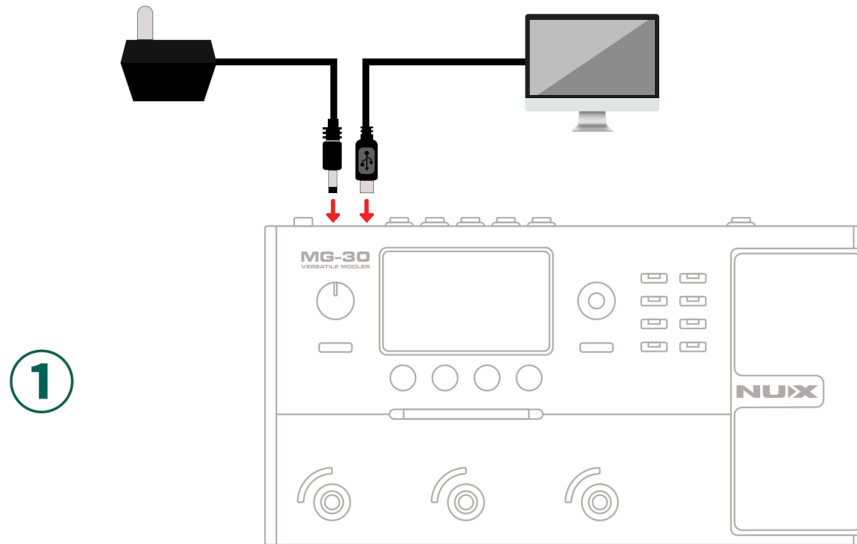

2. Run "NUX DFU Updater"
3. Press and hold down both the **Down** and **Up** foot-switches while turning on the power switch, release the foot-switches until you see "Device Firmware Update" on MG-30's display; the "NUX DFU Updater" should now indicates "Device Connected"

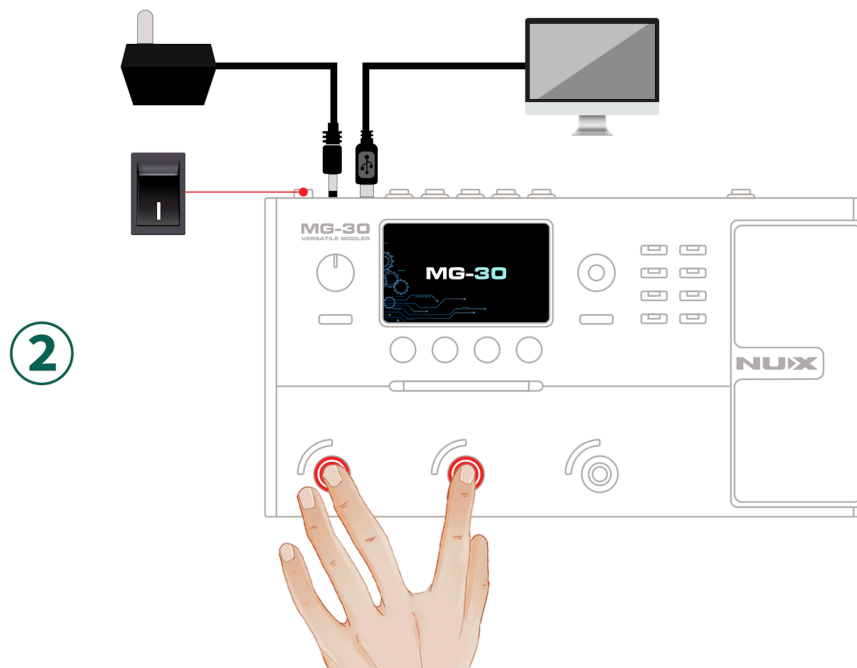

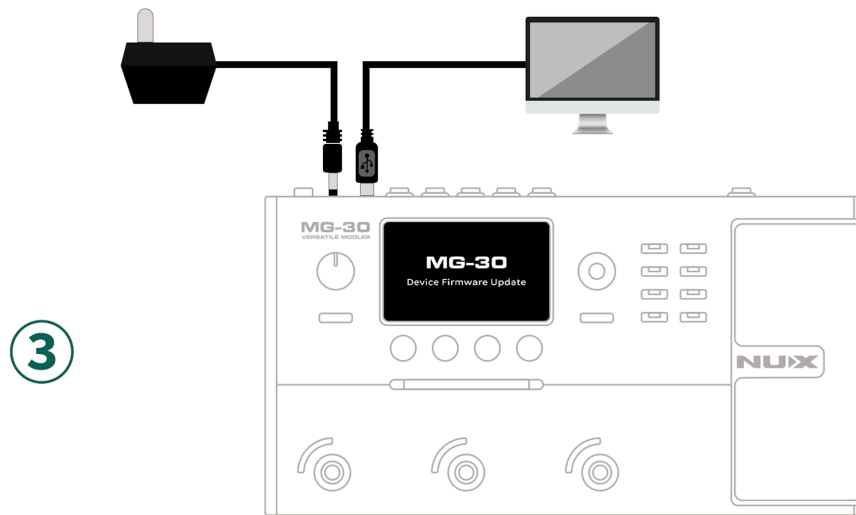

- Updating the firmware.

1. Select the new firmware bin file; Click "Start Update" button to proceed.
2. Wait until the progress ends.

**WARNING: DO NOT Unplug the USB-C Cable nor the Power Supply during the update.**

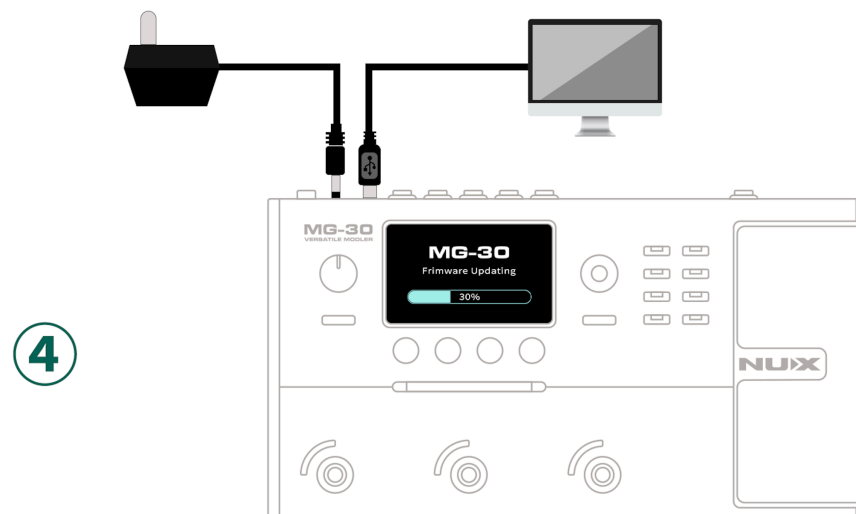

3. When the firmware update process is complete, close "NUX DFU Updater", disconnect the USB-C cable and turn off the power switch.

- 
- If you have any problem, please feel free to contact us by email. [info@cherubtechnology.com](mailto:info@cherubtechnology.com)